

HiTech

INDUSTRIES

ISO 9001:2015 CERTIFIED COMPANY



Clarity in Every Glass

Hitech Industries - Your Trusted Visionary in Quality and Service



About US

Welcome to **HI-TECH INDUSTRIES**, where precision meets innovation in the manufacturing of high-quality ms (mild steel), ss (stainless steel), and ptfe (polytetrafluoroethylene) sight glass and valve solutions. As a leading player in the industry, hi-tech industries is committed to delivering cutting-edge products that not only meet but exceed the expectations of our discerning clients.

With a steadfast focus on technological advancement and uncompromising quality, we take pride in our ability to engineer sight glass and valve solutions that cater to a diverse range of industrial applications. Our dedication to excellence is evident in every aspect of our production process, ensuring that each product leaving our facility is a testament to precision craftsmanship and durability.

At hi-tech industries, we understand the critical role that sight glasses and valves play in various industrial processes. Whether you require robust solutions for monitoring, controlling, or regulating the flow of liquids or gases, our products are designed to meet the challenges of the most demanding environments.

As a customer-centric company, we prioritize not only the quality of our products but also the satisfaction of our clients. Our experienced team of professionals is committed to providing personalized service, technical expertise, and timely delivery, making **HI-TECH INDUSTRIES** your trusted partner in the pursuit of operational excellence.



SS/MS ALLEN KEY TYPE SIGHT GLASS

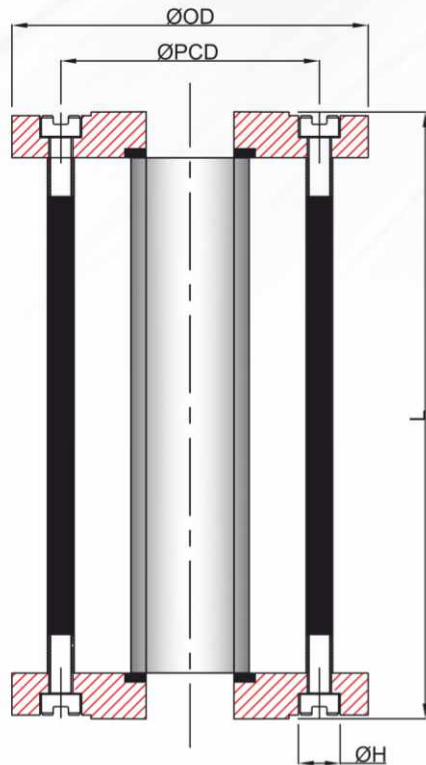

Dimension Table #150

Size	OD(±3)	PCD	L(±3)	ØD	N.H
15NB	90	60	170	16	4
20NB	100	70	170	16	4
25NB	108	79	170	16	4
40NB	127	98	175	16	4
50NB	152	121	175	19	4
65NB	180	140	180	19	4
80NB	191	152	180	19	4
100NB	229	191	180	19	8
150NB	279	241	190	22	8
200NB	343	298	200	22	8
250NB	406	362	220	25	12
300NB	483	432	220	25	12

Material Specification

No.	DESCRIPTION	MATERIAL	Qty.
1	FLANGE	CS/CF8/CF8M/CF3M	2
2	GASKET	PTFE	2
3	GLASS TUBE	BOROSILICATE	1
4	TIE ROD	CS/CF8/CF8M/CF3M	4/8/12
5	ALLEN KEY BOLT	MS/SS 304/316/202/A2	-
6	SAFETY SHIELD	POLYCARBONATE/ACRYLIC	1

Salient Features:

1. Full Visualize Design.
2. Easy Maintenance.
3. Unrestricted Full Bore Flow.

Available Option :

1. Custom Face To Face Length Available As Per Customer Requirement.
2. Acrylic Protection Tube Can Be Provided For Additional Safety.
3. Welded Frame.
4. Outer Finish For MS Sight Glass Finish Powder Coating/Zinc Coating/Other Coating.
5. Outer Finish For SS Sight Glass Mirror Polish/Electro Polish/Matte Polish.
6. Custom Flange (F Table/ E Table) PCD Design Will Be Made As Per Customer Requirement.
7. Availability In Various Sealing (PTFE, VITON & EPDM).
8. Available In Two Glass Length 4" (100mm) And 6" (150mm).

PRESSURE TESTING

TEST TYPE	UNIT	HYD. PRESSURE TEST
SHEEL (BODY)	KG/CM ²	5
	PSI	71
	BAR	5

Lined **MS/SS** ALLEN KEY TYPE SIGHT GLASS

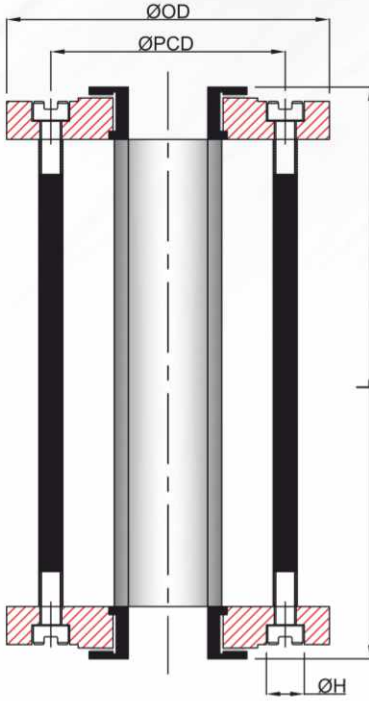

Dimension Table #150

Size	OD(±3)	PCD	L(±3)	ØD	N.H
25NB	108	79	175	16	4
40NB	127	98	180	16	4
50NB	152	121	180	19	4
65NB	180	140	185	19	4
80NB	191	152	190	19	4
100NB	229	191	190	19	8
150NB	279	241	205	22	8
200NB	343	298	215	22	8
250NB	406	362	215	25	12
300NB	483	432	220	25	12

Material Specification

No.	DESCRIPTION	MATERIAL	Qty.
1	FLANGE	CS/CF8/CF8M/CF3M	2
2	LINING	FEP/PFA/PTFE	2
3	GASKET	PTFE	2
4	GLASS TUBE	BOROSILICATE	1
5	TIE ROD	CS/CF8/CF8M/CF3M	4/8/12
6	ALLEN KEY BOLT	MS/SS 304/316/202/A2	-
7	SAFETY SHIELD	POLYCARBONATE/ACRYLIC	1

Salient Features:

1. All Wetted Parts Are Borosilicate And PTFE.
2. Full Visualize Design.
3. All Sight Glass Spark Tested At 15KVA.
4. Easy Maintenance.
5. Unrestricted Full Bore Flow.
6. Corrosion Proof Application.

Available Option :

1. Custom Face to Face Length Available As Per Customer Requirement.
2. Acrylic Protection Tube Can Be Provided For Additional Safety.
3. Outer Finish For MS Sight Glass Finish Powder Coating/Zinc Coating/Other Coating.
4. Outer Finish For SS Sight Glass Mirror Polish/Electro Polish/Matte Polish.
5. Custom Flange (F Table/ E Table) PCD Design Will Be Made As Per Customer Requirement.
6. Availability In Various Sealing (PTFE, VITON and EPDM).
7. Available In two Glass length 4" (100mm) and 6" (150mm).

PRESSURE TESTING

TEST TYPE	UNIT	HYD. PRESSURE TEST
SHEEL (BODY)	KG/CM ²	5
	PSI	71
	BAR	5

SS/MS ALLEN KEY WITH T-BUSH TYPE SIGHT GLASS

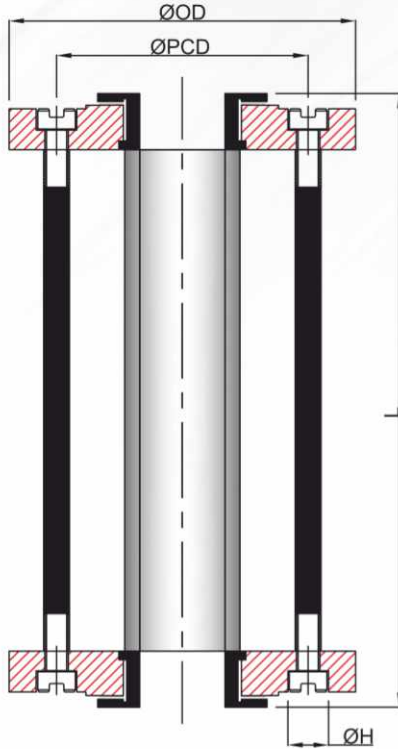

Dimension Table #150

Size	OD(±3)	PCD	L(±3)	ØD	N.H
25NB	108	79	175	16	4
40NB	127	98	180	16	4
50NB	152	121	180	19	4
65NB	180	140	185	19	4
80NB	191	152	190	19	4
100NB	229	191	190	19	8
150NB	279	241	205	22	8
200NB	343	298	215	22	8
250NB	406	362	215	25	12
300NB	483	432	220	25	12

Material Specification

No.	DESCRIPTION	MATERIAL	Qty.
1	FLANGE	CS/CF8/CF8M/CF3M	2
2	T-BUSH	PTFE	2
3	GASKET	PTFE	2
4	GLASS TUBE	BOROSILICATE	1
5	TIE ROD	CS/CF8/CF8M/CF3M	4/8/12
6	ALLEN KEY BOLT	MS/SS 304/316/202/A2	-
7	SAFETY SHIELD	POLYCARBONATE/ACRYLIC	1

Salient Features:

1. All Wetted Parts Are Borosilicate And PTFE.
2. Full Visualize Design.
3. Easy Maintenance.
4. Unrestricted Full Bore Flow.
5. Corrosion Proof Application.

Available Option :

1. Custom Face To Face Length Available As Per Customer Requirement.
2. Acrylic Protection Tube Can Be Provided For Additional Safety.
3. Outer Finish For MS Sight Glass Finish Powder Coating/Zinc Coating/Other Coating.
4. Outer Finish For SS Sight Glass Mirror Polish/Electro Polish/Matte Polish.
5. Custom Flange (F Table/ E Table) PCD Design Will Be Made As Per Customer Requirement.
6. Availability In Various Sealing (PTFE, Viton & EPDM).
7. Available In two Glass length 4" (100mm) And 6" (150mm).

PRESSURE TESTING

TEST TYPE	UNIT	HYD. PRESSURE TEST
SHEEL (BODY)	KG/CM ²	5
	PSI	71
	BAR	5

MS CHECKNUT TYPE SIGHTGLASS

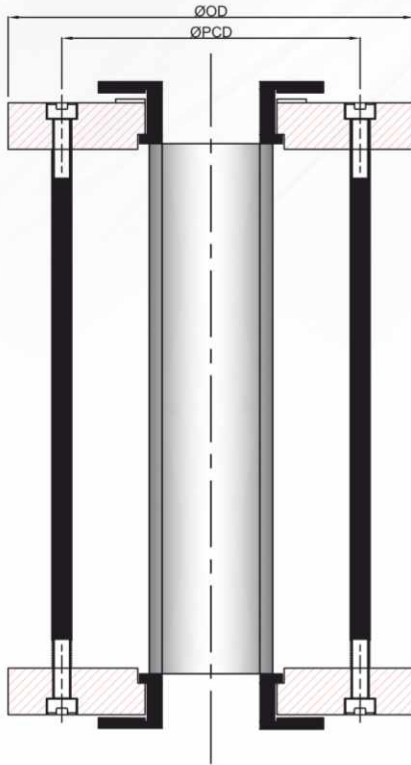

Dimension Table #150

Size	OD(±3)	PCD	L(±3)	ØD	N.H
25NB	108	79	185	16	4
40NB	127	98	190	16	4
50NB	152	121	190	19	4
65NB	180	140	195	19	4
80NB	191	152	200	19	4
100NB	229	191	200	19	8
150NB	279	241	215	22	8

Material Specification

No.	DESCRIPTION	MATERIAL	Qty.
1	FLANGE	CS/CF8/CF8M/CF3M	2
2	T-BUSH	PTFE	2
3	GASKET	PTFE	2
4	GLASS TUBE	BOROSILICATE	1
5	TIE ROD	CS/CF8/CF8M/CF3M	4/8/12
6	ALLEN KEY BOLT	MS/SS 304/316/202/A2	-
7	SAFETY SHIELD	POLYCARBONATE/ACRYLIC	1

Salient Features:

1. All Wetted Parts Are Borosilicate And PTFE.
2. Full Visualize Design.
3. Easy Maintenance.
4. Unrestricted Full Bore Flow.
5. Corrosion Proof Application.

Available Option :

1. Custom Face To Face Length Available As Per Customer Requirement.
2. Acrylic Protection Tube Can Be Provided For Additional Safety.
3. Outer Finish For MS Sight Glass Finish Powder Coating/Zinc Coating/Other Coating.
4. Outer Finish For SS Sight Glass Mirror Polish/Electro Polish/Matte Polish.
5. Custom Flange (F Table/ E Table) PCD Design Will Be Made As Per Customer Requirement.
6. Availability In Various Sealing (PTFE, VITON & EPDM).
7. Available In Two Glass Length 4" (100mm) And 6" (150mm).

PRESSURE TESTING

TEST TYPE	UNIT	HYD. PRESSURE TEST
SHEEL (BODY)	KG/CM ²	5
	PSI	71
	BAR	5

INVESTMENT CASTING TYPE SIGHT GLASS

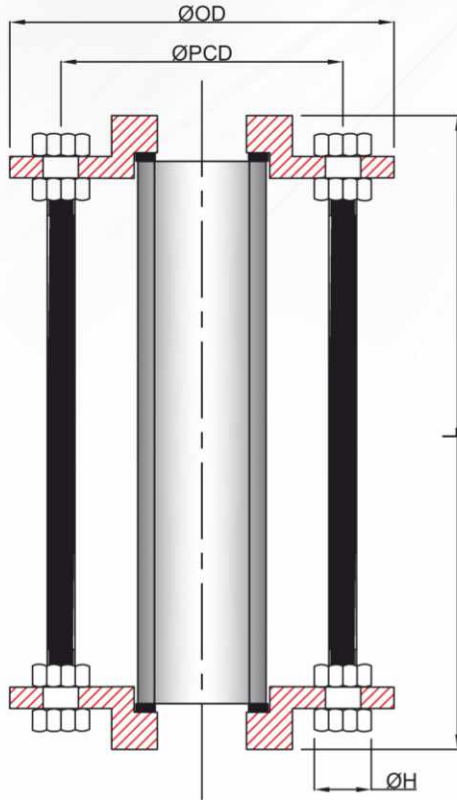

Dimension Table #150

Size	OD(±3)	PCD	L(±3)	ØD	N.H
15NB	90	60	170	16	4
25NB	108	79	170	16	4
40NB	127	98	170	19	4
50NB	152	121	170	19	4
65NB	180	140	170	19	4
80NB	191	152	170	19	8
100NB	229	191	175	22	8
150NB	279	241	180	22	8
200NB	343	298	180	22	8

Salient Features:

1. Full Visualize Design.
2. Easy Maintenance.
3. Light Weight.
4. Unrestricted Full Bore Flow.
5. Corrosion Proof Application.

Available Option :

1. Custom Face to Face Length Available As Per Customer Requirement.
2. Acrylic Protection Tube Can Be Provided For Additional Safety.
3. Outer Finish For SS Sight Glass Mirror Polish/Electro Polish/Matte Polish.
4. Availability in Various Sealing (PTFE, VITON & EPDM).
5. Available In Two Glass Length 4" (100mm) And 6" (150mm).

Material Specification

No.	DESCRIPTION	MATERIAL	Qty.
1	FLANGE	CF8/CF8M/CF3M	2
2	GASKET	PTFE	2
3	GLASS TUBE	BOROSILICATE	1
4	TIE ROD	SS 304/316/202	4/8/12
5	STUD BOLT	SS 304/316/202	-
6	SAFETY SHIELD	POLYCARBONATE/ACRYLIC	1

PRESSURE TESTING

TEST TYPE	UNIT	HYD. PRESSURE TEST
SHEEL (BODY)	KG/CM ²	5
	PSI	71
	BAR	5

INVESTMENT CASTING TYPE SIGHT GLASS (WITH T-BUSH TYPE)

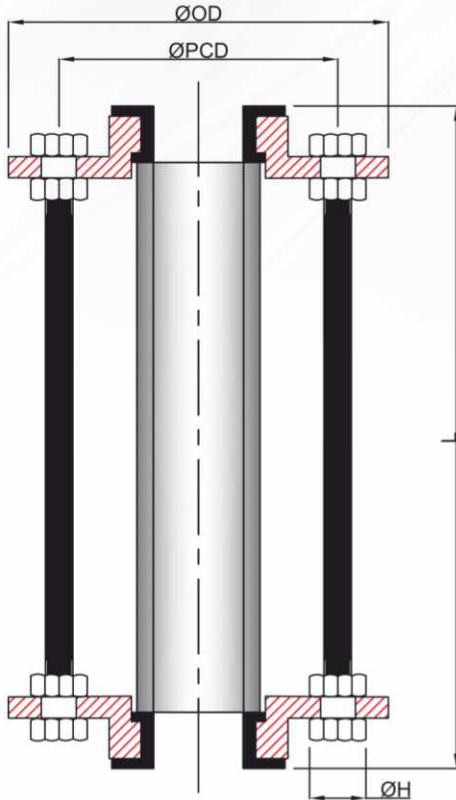

Dimension Table #150

Size	OD(±3)	PCD	L(±3)	ØD	N.H
15NB	90	60	175	16	4
25NB	108	79	175	16	4
40NB	127	98	175	19	4
50NB	152	121	175	19	4
65NB	180	140	175	19	4
80NB	191	152	175	19	8
100NB	229	191	180	22	8
150NB	279	241	185	22	8
200NB	343	298	185	22	8

Material Specification

No.	DESCRIPTION	MATERIAL	Qty.
1	FLANGE	CF8/CF8M/CF3M	2
2	GASKET	PTFE	2
3	T-BUSH	PTFE	2
4	GLASS TUBE	BOROSILICATE	1
5	TIE ROD	SS 304/316/202	4/8/12
6	STUD BOLT	SS 304/316/202	-
7	SAFETY SHIELD	POLYCARBONATE/ACRYLIC	1

Salient Features:

1. All Wetted Parts Are Borosilicate And PTFE.
2. Full Visualize Design.
3. Easy Maintenance.
4. Light Weight.
5. Unrestricted Full Bore Flow.
6. High Corrosion Proof Application.

Available Option :

1. Custom Face to Face Length Available As Per Customer Requirement.
2. Acrylic Protection Tube Can Be Provided For Additional Safety.
3. Outer Finish For SS Sight Glass Mirror Polish/Electro Polish/Matte Polish.
4. Availability In various sealing (PTFE, VITON & EPDM).
5. Available In Two Glass Length 4" (100mm) And 6" (150mm).

PRESSURE TESTING

TEST TYPE	UNIT	HYD. PRESSURE TEST
SHEEL (BODY)	KG/CM ²	5
	PSI	71
	BAR	5

INVESTMENT CASTING TYPE SIGHT GLASS (PTFE LINED TYPE)

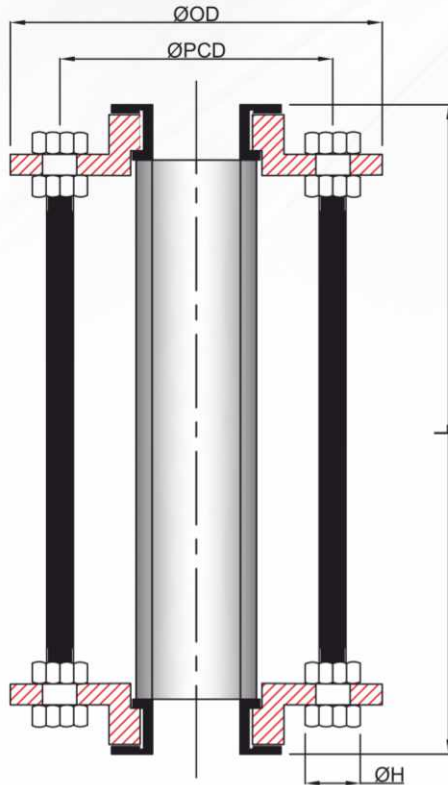

Dimension Table #150

Size	OD(±3)	PCD	L(±3)	ØD	N.H
15NB	90	60	175	16	4
25NB	108	79	175	16	4
40NB	127	98	175	19	4
50NB	152	121	175	19	4
65NB	180	140	175	19	4
80NB	191	152	175	19	8
100NB	229	191	180	22	8
150NB	279	241	185	22	8
200NB	343	298	185	22	8

Salient Features:

1. All Wetted Parts Are Borosilicate And PTFE.
2. Full Visualize Design.
3. Easy Maintenance.
4. Light Weight.
5. Unrestricted Full Bore Flow.
6. High Corrosion Proof Application.
7. All Sight Glass Spark Tested At 15KVA.

Available Option :

1. Custom Face to Face Length Available As Per Customer Requirement.
2. Acrylic Protection Tube Can Be Provided For Additional Safety.
3. Outer Finish For SS Sight Glass Mirror Polish/Electro Polish/Matte Polish.
4. Availability In Various Sealing (PTFE, Viton and EPDM).
5. Available In Two Glass Length 4" (100mm) and 6" (150mm).

Material Specification

No.	DESCRIPTION	MATERIAL	Qty.
1	FLANGE	CF8/CF8M/CF3M	2
2	GASKET	PTFE	2
3	LINING	PTFE	2
4	GLASS TUBE	BOROSILICATE	1
5	TIE ROD	CS/CF8/CF8M/CF3M	4/8/12
6	STUD BOLT	SS 202/CF8/CF8M	-
7	SAFETY SHIELD	POLYCARBONATE/ACRYLIC	1

PRESSURE TESTING

TEST TYPE	UNIT	HYD. PRESSURE TEST
SHEEL (BODY)	KG/CM ²	5
	PSI	71
	BAR	5

TC END TUBULAR TYPE SIGHT GLASS

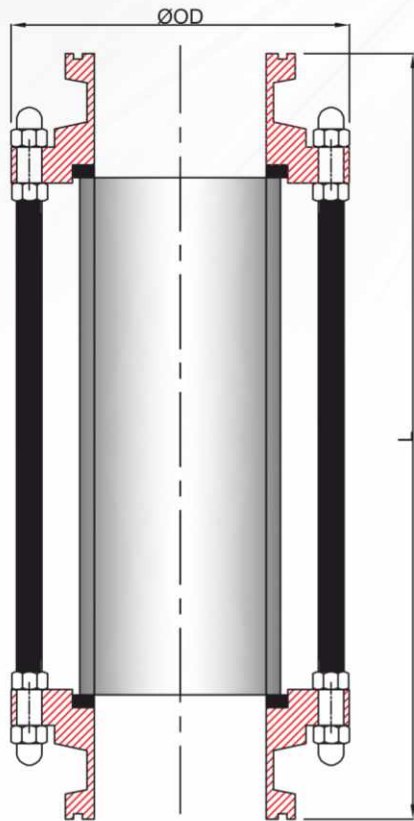

Dimension Table #150

Size	OD(±3)	L(±3)
25NB	50	220
40NB	50	220
50NB	63	220
65NB	76	220
80NB	90	220
100NB	118	220
150NB	168	220
200NB	217	220

Salient Features:

1. Full Visualize Design.
2. Easy Maintenance.
3. Light Weight.
4. Unrestricted Full Bore Flow.
5. Corrosion Proof Application.
6. Suitable For Dairy and Food Industries.
7. Quick Fixing And Quick Cleaning Can Be Done Easily.
8. Tri-Clover Connections.

Available Option :

1. Custom Face To Face Length Available As Per Customer Requirement.
2. Acrylic Protection Tube Can Be Provided For Additional Safety.
3. Outer Finish For SS Sight Glass Mirror Polish/Electro Polish/Matte Polish.
4. Availability In Various Sealing (PTFE, Viton and EPDM).
5. Available In Two Glass Length 4" (100mm) and 6" (150mm).

Material Specification

No.	DESCRIPTION	MATERIAL	Qty.
1	FLANGE	CF8/CF8M/CF3M	2
2	GASKET	PTFE	2
3	GLASS TUBE	BOROSILICATE	1
4	TIE ROD	CF8/CF8M/CF3M	-
5	STUD BOLT	SS 202/CF8/CF8M	-
6	SAFETY SHIELD	POLYCARBONATE/ACRYLIC/SS	1

PRESSURE TESTING

TEST TYPE	UNIT	HYD. PRESSURE TEST
SHEEL (BODY)	KG/CM ²	5
	PSI	71
	BAR	5

SCREWED-END TYPE SIGHT GLASS

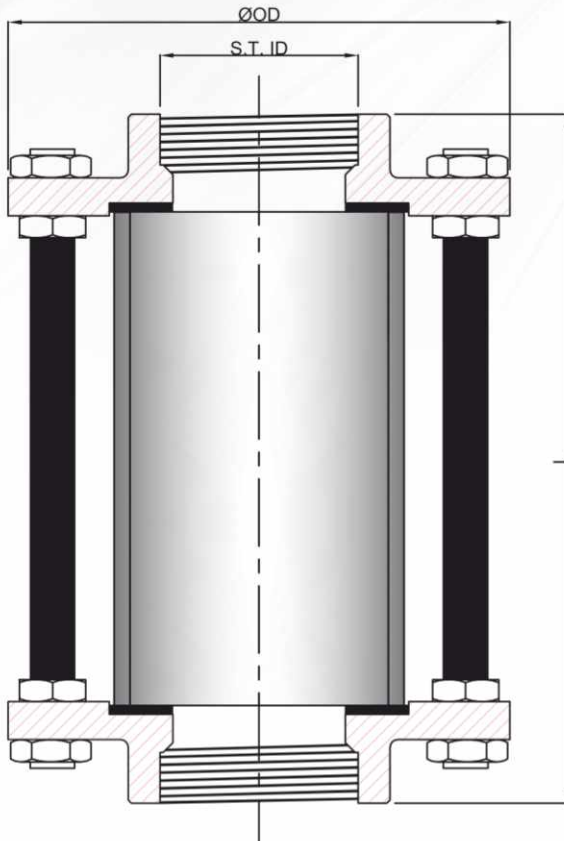

Dimension Table #150

Size	Threaded ID	OD(±3)	L(±3)
8NB	12.5	54	150
10NB	16	54	150
15NB	19.5	54	150
20NB	25	54	150
25NB	31	54	150
40NB	46	76	150
50NB	58	86	150

Salient Features:

1. Full Visualize Design.
2. Easy Maintenance.
3. Light Weight.
4. Unrestricted Full Bore Flow.

Available Option :

1. Custom Face To Face Length Available As Per Customer Requirement.
2. Acrylic Protection Tube Can Be Provided For Additional Safety.
3. Outer Finish For SS Sight Glass Mirror Polish/Electro Polish/Matte Polish.
4. NPT Threaded Connection As Per ANSI.
5. Availability In Various Sealing (PTFE, VITON & EPDM).
6. Available In Two Glass Length 4" (100mm) And 6" (150mm).

Material Specification

No.	DESCRIPTION	MATERIAL	Qty.
1	FLANGE	WCB/CF8/CF8M/CF3M	2
2	GASKET	PTFE	2
3	GLASS TUBE	BOROSILICATE	1
4	TIE ROD	MS/SS 304/316/202	-
5	FASTENERS	MS/SS 304/316/202	-
6	SAFETY SHIELD	POLYCARBONATE/ACRYLIC	1

PRESSURE TESTING

TEST TYPE	UNIT	HYD. PRESSURE TEST
SHEEL (BODY)	KG/CM ²	5
	PSI	71
	BAR	5

PP/PVDF TUBULAR SIGHT FLOW INDICATORS

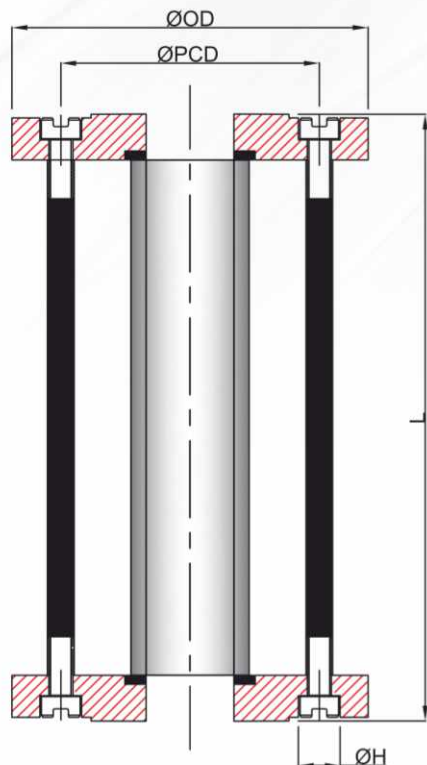

Dimension Table

Size	OD(±3)	PCD	H(No.)	H DIA	L(±3)
25NB	108	79	4	16	219
40NB	127	98	4	16	219
50NB	152	121	4	19	245
65NB	180	140	4	19	250
80NB	191	152	4	19	269
100NB	229	191	8	19	275
150NB	279	241	8	22	2

Material Specification

No.	DESCRIPTION	Qty.	MATERIAL
1	FLANGE	2	PPCP/PP/PPH/ISOPP/PVDF
2	GASKET	2	PTFE/VITON
3	GLASS TUBE	1	BOROSILICATE
4	TIE ROD	-	MS/SS 304/316/202/A2
5	FASTENERS	-	MS/SS 304/316/202/A2
6	SAFETY SHIELD	1	POLYCARBONATE/ACRYLIC

Salient Features:

1. All Wetted Parts Are Borosilicate And PP.
2. Full Visualize Design.
3. Easy Maintenance.
4. Unrestricted Full Bore Flow.
5. Low Weight.

Available Option :

1. Custom Face To Face Length Available As Per Customer Requirement.
2. Acrylic Protection Tube Can Be Provided For Additional Safety.
3. Available In Two Glass Length 4" (100mm) and 6" (150mm).
4. Availability In Various Sealing (PTFE, VITON & EPDM).
5. Custom Flange (F Table/ E Table) PCD Design Will Be Made As Per Customer Requirement.
6. Availability In Various Sealing (PTFE, VITON & EPDM).

PRESSURE TESTING

TEST TYPE	UNIT	HYD. PRESSURE TEST
SHEEL (BODY)	KG/CM ²	2
	PSI	28
	BAR	2

SS/MS DOUBLE WINDOW TYPE SIGHT GLASS

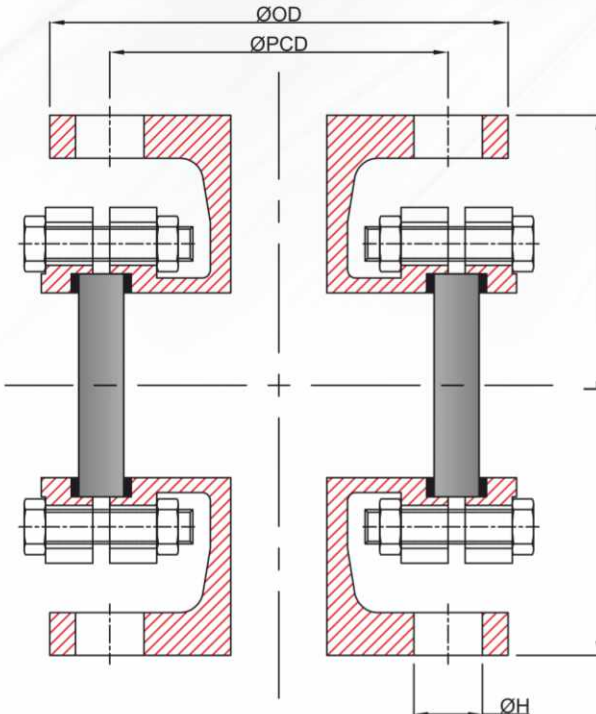

Dimension Table #150

Size	OD(±3)	PCD	L(±3)	ØD	N.H
25NB	108	79	127	16	4
40NB	127	98	165	16	4
50NB	152	121	178	19	4
65NB	180	140	191	19	4
80NB	191	152	203	19	4
100NB	229	191	229	19	8
150NB	279	241	267	22	8
200NB	343	298	520	22	8
250NB	406	362	600	25	12
300NB	483	432	650	25	12

Salient Features:

1. Large View Area.
2. Easy Maintenance.
3. Durable Construction.
4. High Pressurised Application Use.

Available Option :

1. Flapper Type And Rotary Wheel Type Design Is Also Available.
2. Outer Finish For MS Sight Glass Finish Powder Coating/Zinc Coating/Other Coating.
3. Outer Finish For SS Sight Glass Mirror Polish/Electro Polish/Matte Polish.
4. Upto 150NB Investment Casting and 200NB onwards Fabricated Design.
5. Custom Made Design Can Be Fabricated On Request.
6. Custom Flange (F Table/ E Table) PCD Design Will Be Made As Per Customer Requirement.
7. Availability In Various Sealing (PTFE, VITON & EPDM).

Material Specification

No.	DESCRIPTION	MATERIAL	Qty.
1	BODY	CS/CF8/CF8M/CF3M	1
2	GASKET	PTFE	2
3	GLASS TUBE	TOUGHENED GLASS	2
4	ALLEN KEY BOLT	MS/SS 304/316/202/A2	-

PRESSURE TESTING

TEST TYPE	UNIT	HYD. PRESSURE TEST
SHEEL (BODY)	KG/CM ²	10
	PSI	140
	BAR	10

LINED DOUBLE WINDOW TYPE SIGHT GLASS

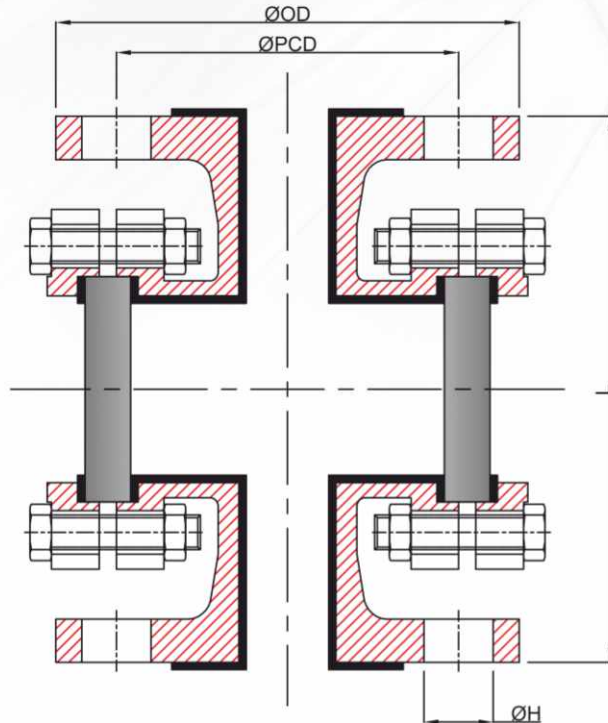

Dimension Table #150

Size	OD(±3)	PCD	L(±3)	ØD	N.H	Lining Thk.
25NB	108	79	178	16	4	3
40NB	127	98	204	16	4	3
50NB	152	121	228	19	4	3
65NB	180	140	254	19	4	3
80NB	191	152	280	19	4	3
100NB	229	191	330	19	8	3
150NB	279	241	406	22	8	3.5
200NB	343	298	458	22	8	3.5
250NB	406	362	558	25	12	4
300NB	483	432	610	25	12	4

Salient Features:

1. High Corrosion Proof Application.
2. Large View Area.
3. Easy Maintenance.
4. Durable Construction.
5. High Pressurised Application Use.

Available Option :

1. Outer Finish For SS Sight Glass Mirror Polish/Electro Polish/Matte Polish.
2. Custom Made Design Can Be Fabricated On Request.
3. Custom Flange (F Table/ E Table) PCD Design Will Be Made As Per Customer Requirement.
4. Can Withstand High Temperatures Upto 200 °C (PFA).
5. Spark Tested at 15KVA.
6. Availability in various sealing (PTFE, VITON & EPDM).

Material Specification

No.	DESCRIPTION	MATERIAL	Qty.
1	BODY	CS/CF8/CF8M/CF3M	1
2	LINING	FEP/PFA	1
2	GASKET	PTFE	2
3	GLASS TUBE	TOUGHENED GLASS	2
4	ALLEN KEY BOLT	MS/SS 304/316/202/A2	-

PRESSURE TESTING

TEST TYPE	UNIT	HYD. PRESSURE TEST
SHEEL (BODY)	KG/CM ²	10
	PSI	140
	BAR	10

PP DOUBLE WINDOW SIGHT GLASS

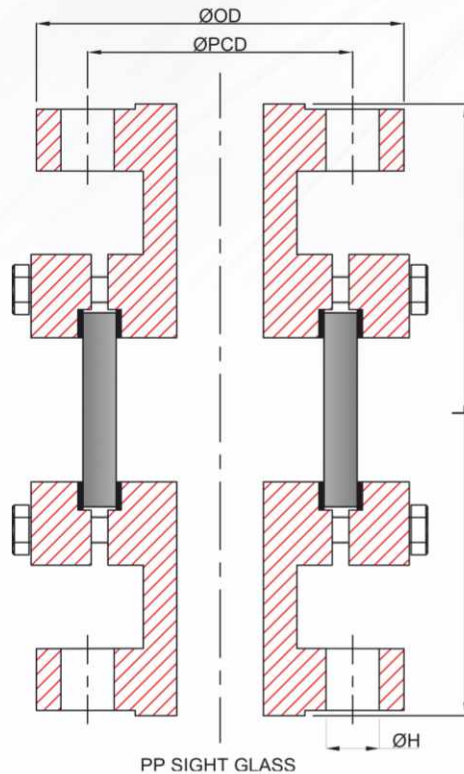

Dimension Table #150

Size	OD(±3)	PCD	L(±3)	ØD	N.H
25NB	108	79	127	16	4
40NB	127	98	165	16	4
50NB	152	121	178	19	4
65NB	180	140	191	19	4
80NB	191	152	203	19	4
100NB	229	191	229	19	8
150NB	279	241	267	22	8

Material Specification

No.	DESCRIPTION	MATERIAL	Qty.
1	BODY	PP	1
2	GASKET	PTFE	2
3	GLASS TUBE	TOUGHENED GLASS	2
4	ALLEN KEY BOLT	MS/SS 304/316/202/A2	-

Salient Features :

1. Large View Area.
2. Light Weight Construction.
3. Easy Maintenance.

Available Option :

1. Custom Made Design Can Be Fabricated On Request.
2. Custom Flange (F Table/ E Table) PCD Design Will Be Made As Per Customer Requirement.
3. Availability In Various Sealing (PTFE, VITON & EPDM).

PRESSURE TESTING

TEST TYPE	UNIT	HYD. PRESSURE TEST
SHEEL (BODY)	KG/CM ²	2
	PSI	28
	BAR	2

CIRCULAR TANK MOUNTED SIGHT GLASS

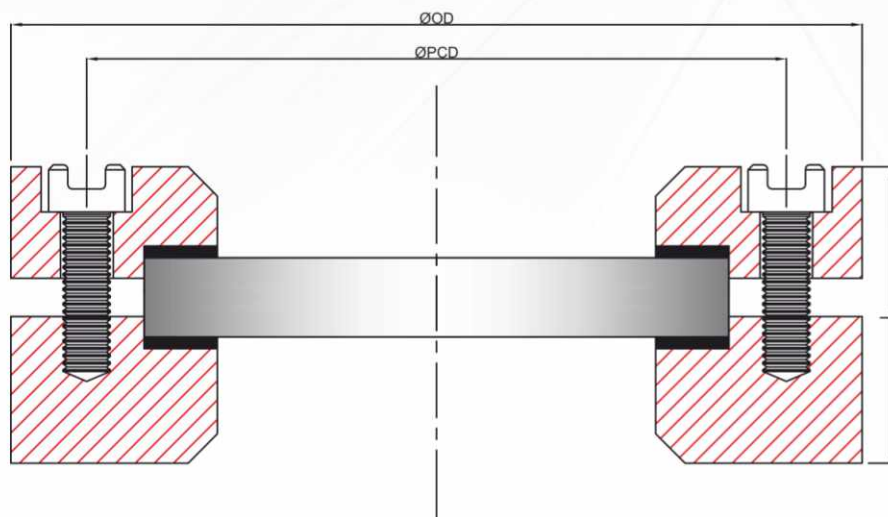

WELD PAD SIGHT GLASS



Dimension Table

Size	OD(±3)	L(±3)	View	N.H
50NB	152	30	75	4
80NB	190	40	100	4
100NB	230	40	125	8
125NB	255	50	150	8
150NB	280	50	175	8
200NB	340	50	225	8

Material Specification

No.	DESCRIPTION	MATERIAL	Qty.
1	FLANGE	CS/CF8/CF8M/CF3M	2
2	GASKET	PTFE	2
3	GLASS	TOUGHENED GLASS	1
4	FASTNERS	MS/SS 304/316/202/A2	-

Salient Features:

1. All Wetted Parts Are Toughened Glass & SS.
2. Full Visualize Design.
3. Easy Maintenance.
4. Easy Installation.

Available Option :

1. Special Design Sight Glass For Curved Surfaces Can Be Provided On Request.
2. Mounted Or Welded Onto Pressurized, Non-pressurized And High Temperature Tanks Or Vessels.
3. Provides Clear, Continuous Process Or Products In The Tanks Or Vessels.
4. Availability In Various Sealing (PTFE, VITON & EPDM).
5. Wiper Type Glass Available.

PRESSURE TESTING

TEST TYPE	UNIT	HYD. PRESSURE TEST
SHEEL (BODY)	KG/CM ²	8
	PSI	112
	BAR	8

OBROUND TANK MOUNTED SIGHT GLASS

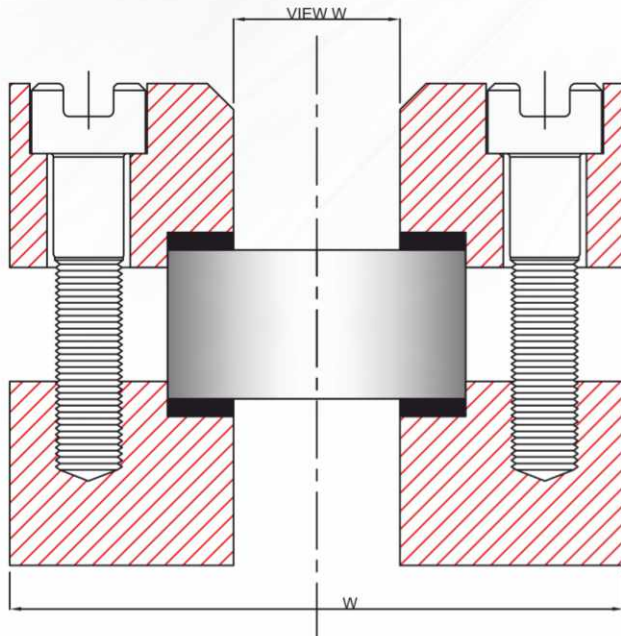

WELD PAD TANK SIGHT GLASS



Dimension Table

W	L	L(±3)	View	View
90	250	1	25	1X200
90	300	1	25	1X250
90	350	1	25	1X300
90	400	1	25	1X350
90	500	2	25	2X200
90	600	2	25	2X250
90	700	2	25	2X300
90	800	2	25	2X350
90	1000	4	25	4X200

Salient Features:

1. All Wetted Parts Are Toughened Glass & SS.
2. Full Visualize Design.
3. Easy Maintenance.
4. Easy Installation.

Available Option :

1. Special Design Sight Glass For Curved Surfaces Can Be Provided On Request.
2. Mounted Or Welded Onto Pressurized, Non-pressurized And High Temperature Tanks Or Vessels.
3. Provides Clear, Continuous Process Or Products In The Tanks Or Vessels.
4. Availability in various sealing (PTFE, VITON & EPDM).

Material Specification

No.	DESCRIPTION	MATERIAL	Qty.
1	FLANGE	CS/CFB/CF8M/CF3M	2
2	GASKET	PTFE	2
3	GLASS	TOUGHENED GLASS	1
4	FASTNERS	MS/SS 304/316/202/A2	-

PRESSURE TESTING

TEST TYPE	UNIT	HYD. PRESSURE TEST
SHEEL (BODY)	KG/CM ²	8
	PSI	112
	BAR	8

LINED AZEOTROPIC SEPARATION TUBULAR TYPE SIGHT GLASS

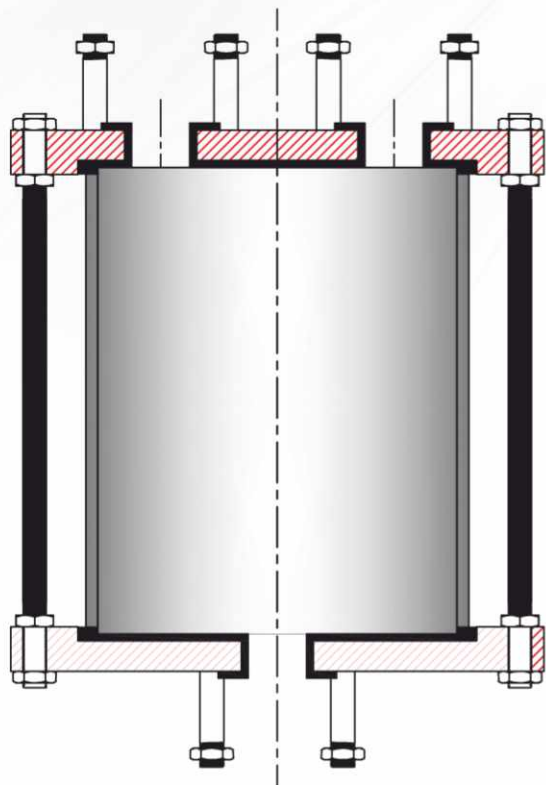

Dimension Table

HI-TECH has designed and supplied many different types of special sight glasses. We can supply tubular sight glass types with the same stainless steel tie rod cage and heavy wall borosilicate glass as our range of CTSG sight glasses but with specially manufactured flange ends to suit customer connection requirements. The flange ends can be supplied with PFA liner to suit corrosive processes or unlined stainless steel as required. Internal like entry pipes can be fitted to help with liquid separation. Diameter up to 18" NB are possible with overall lengths to 1mtr.

Salient Features:

1. All Wetted Parts Are Borosilicate And PTFE.
2. Full Visualize Design.
3. Easy Maintenance.
4. Corrosion Proof Application.

Available Option :

1. Custom Face To Face Length Available As Per Customer Requirement.
2. Acrylic Protection Tube Can Be Provided For Additional Safety.
3. Outer Finish For SS Sight Glass Mirror Polish/Electro Polish/Matte Polish.
4. Availability In Various Sealing (PTFE, VITON & EPDM).

PRESSURE TESTING

TEST TYPE	UNIT	HYD. PRESSURE TEST
SHEEL (BODY)	KG/CM ²	2
	PSI	28
	BAR	2

Material Specification

No.	DESCRIPTION	MATERIAL	Qty.
1	FLANGE	CS/CF8/CF8M/CF3M	2
2	LINING	PTFE/FEP/PFA	2
3	GASKET	PTFE	2
4	GLASS TUBE	BOROSILICATE	1
5	TIE ROD	MS/SS 304/316/202/A2	-
6	FASTENERS	MS/SS 304/316/202/A2	-
7	SAFETY SHIELD	POLYCARBONATE/ACRYLIC	1

AZEOTROPIC SEPARATION TUBULAR TYPE SIGHT GLASS

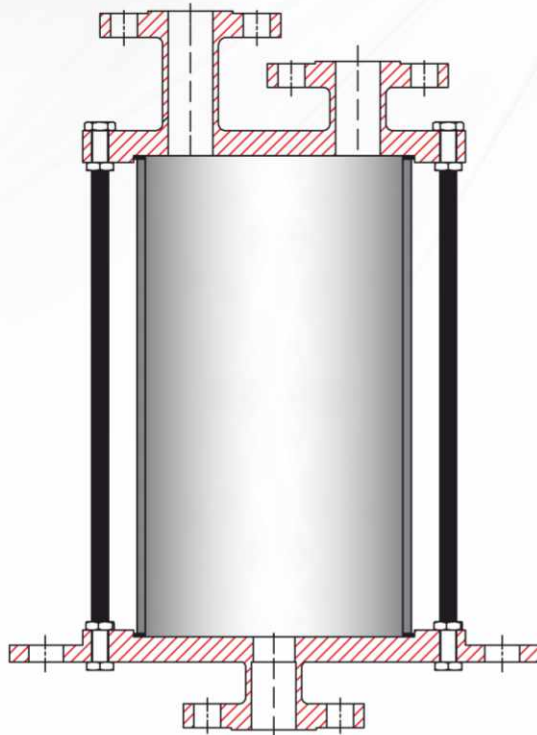

Dimension Table

Hi-tech Has Designed And Supplied Many Different Types Of Special Sight Glasses. We Can Supply Tubular Sight Glass Types With The Same Stainless Steel Tie Rod Cage And Heavy Wall Borosilicate Glass As Our Range Of CTSG Sight Glasses But With Specially Manufactured Flange Ends To Suit Customer Connection Requirements. The Flange Ends Can Be Supplied With PFA Liner To Suit Corrosive Processes Or Unlined Stainless Steel As Required. Internal Like Entry Pipes Can Be Fitted To Help With Liquid Separation. Diameter Up To 18" NB Are Possible With Overall Lengths To 1mtr.

Salient Features:

1. Full Visualize Design.
2. Easy Maintenance.
3. Corrosion Proof Application.

Available Option :

1. Custom Face To Face Length Available As Per Customer Requirement.
2. Acrylic Protection Tube Can Be Provided For Additional Safety.
3. Outer Finish For SS Sight Glass Mirror Polish/Electro Polish/Matte Polish.
4. Availability In Various Sealing (PTFE, VITON & EPDM).

Material Specification

No.	DESCRIPTION	MATERIAL	Qty.
1	FLANGE	CS/CF8/CF8M/CF3M	2
2	GASKET	PTFE	2
3	GLASS TUBE	BOROSILICATE	1
4	TIE ROD	MS/SS 304/316/202/A2	-
5	FASTENERS	MS/SS 304/316/202/A2	-
6	SAFETY SHIELD	POLYCARBONATE/ACRYLIC	1

PRESSURE TESTING

TEST TYPE	UNIT	HYD. PRESSURE TEST
SHEEL (BODY)	KG/CM ²	2
	PSI	28
	BAR	2

SCREW-END DOUBLE WINDOW SIGHT FLOW INDICATORS

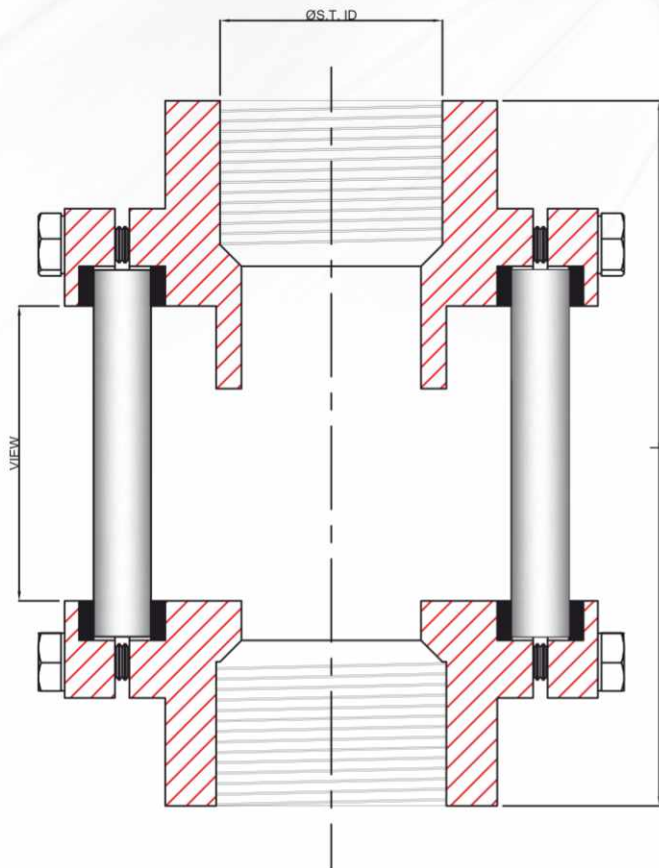

Dimension Table

Size	Screw Thread(S.T. I.D.)	L(±3)
15NB	19.5	90
20NB	25	90
25NB	31	90
40NB	46	125
50NB	58	125

Salient Features:

1. Easy Maintenance.
2. Durable Construction.
3. High Pressurised Application Use.

Available Option :

1. Outer Finish For MS Sight Glass Finish Powder Coating/Zinc Coating/Other Coating.
2. Outer Finish For SS Sight Glass Mirror Polish/Electro Polish/Matte Polish.
3. NPT Threaded Connection As Per ANSI.
4. Availability In Various Sealing (PTFE, VITON & EPDM).

Material Specification

No.	DESCRIPTION	MATERIAL	Qty.
1	BODY	CS/CF8/CF8M/CF3M	1
2	GASKET	PTFE	2
3	GLASS TUBE	TOUGHENED GLASS	2
4	ALLEN KEY BOLT	MS/SS 304/316/202/A2	-

PRESSURE TESTING

TEST TYPE	UNIT	HYD. PRESSURE TEST
SHEEL (BODY)	KG/CM ²	10
	PSI	140
	BAR	10

OUR PRODUCTS

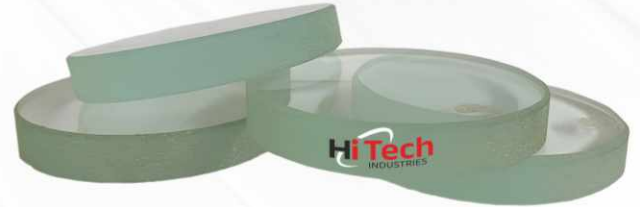

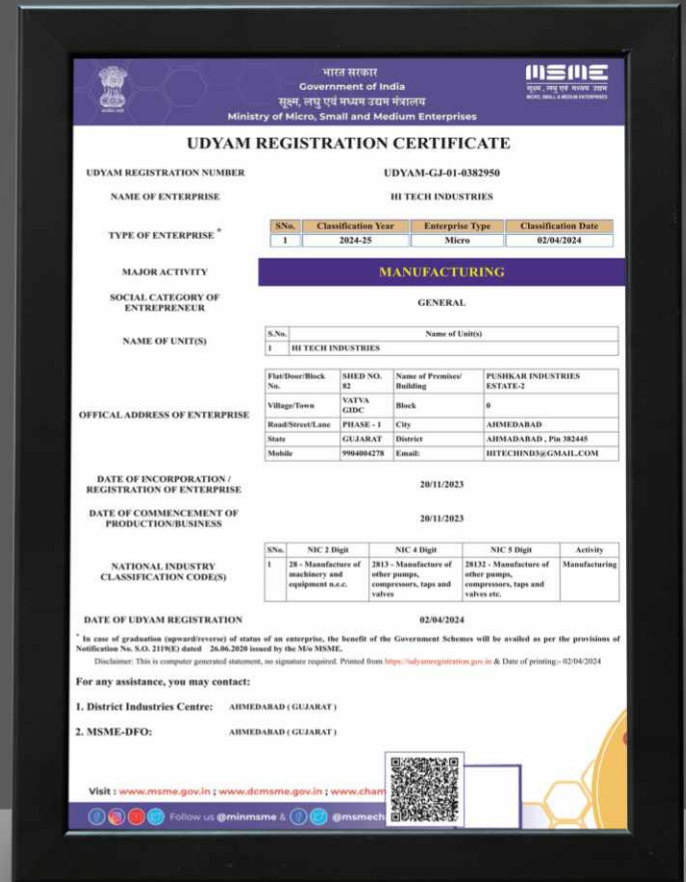

At **Hitech Industries**, we pride ourselves on our unwavering commitment to quality and authentication, ensuring that every industrial sight glass we manufacture meets the highest standards of excellence. Our production processes are characterized by meticulous attention to detail and adherence to stringent quality control measures, guaranteeing that each sight glass delivers unmatched durability, clarity, and reliability. By harnessing advanced technology and the expertise of our skilled craftsmen, we consistently deliver products that exceed customer expectations, earning the trust of industries worldwide.



Industrial Application

- 01) Pharmaceuticals
- 02) Petro Chemical Plant
- 03) Acid & Chemical Plant
- 04) Beverages Plant
- 05) Iron & Steel Plant
- 06) Cement Plant
- 07) Dairy Industries
- 08) Civil Construction
- 09) Automobile Industries
- 10) Heavy Machineries
- 11) Textile Industries
- 12) Power Sectors
- 13) Refineries
- 14) Food Industries
- 15) Sugar Mills
- & Many More....





HiTech
INDUSTRIES

Contact Us :

☎ 9904004278

☎ 6354207168

☎ 8460831731

✉ hitechind3@gmail.com

🌐 www.hitechglass.in

📍 Shed No.82, Pushakar Industries Estate-2 ,Phase-1,
Vatva GIDC, Ahmedabd, Gujarat-382445



For More Information



SCAN ME